

SITE PLAN 1:500 Red boundary line showing site ownership

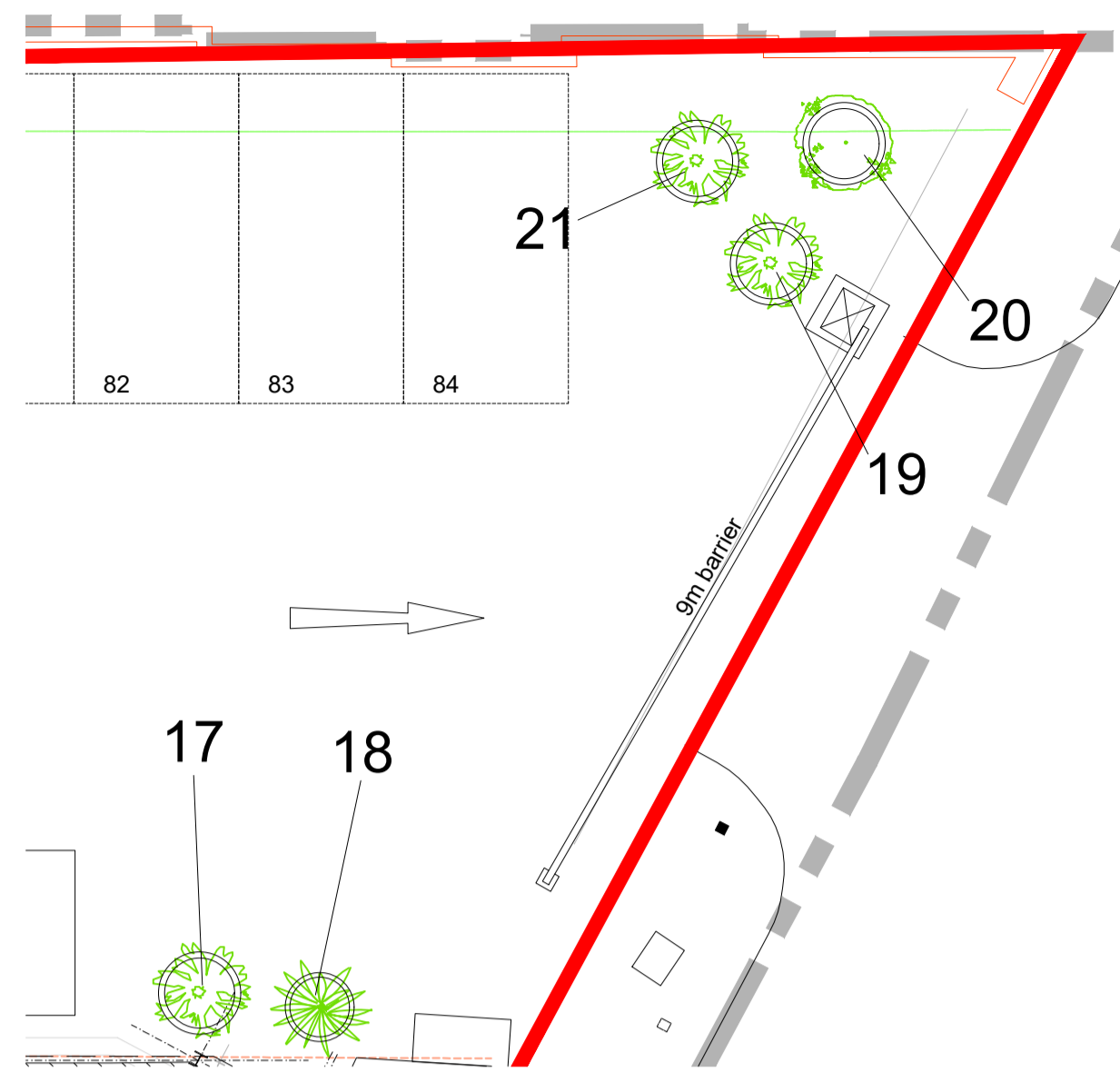

LANDSCAPING PLAN C 1:100

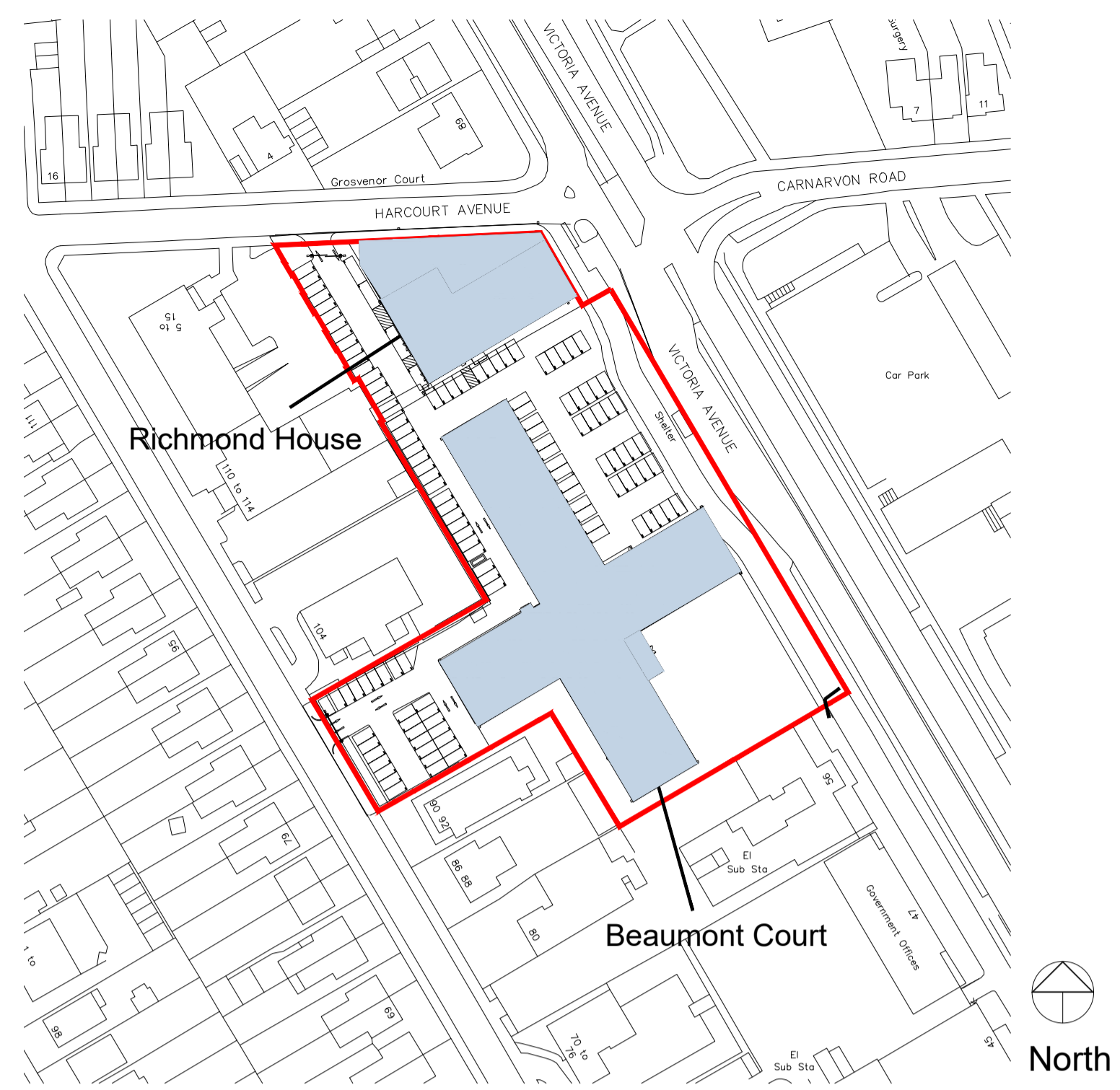

LOCATION PLAN 1:1250

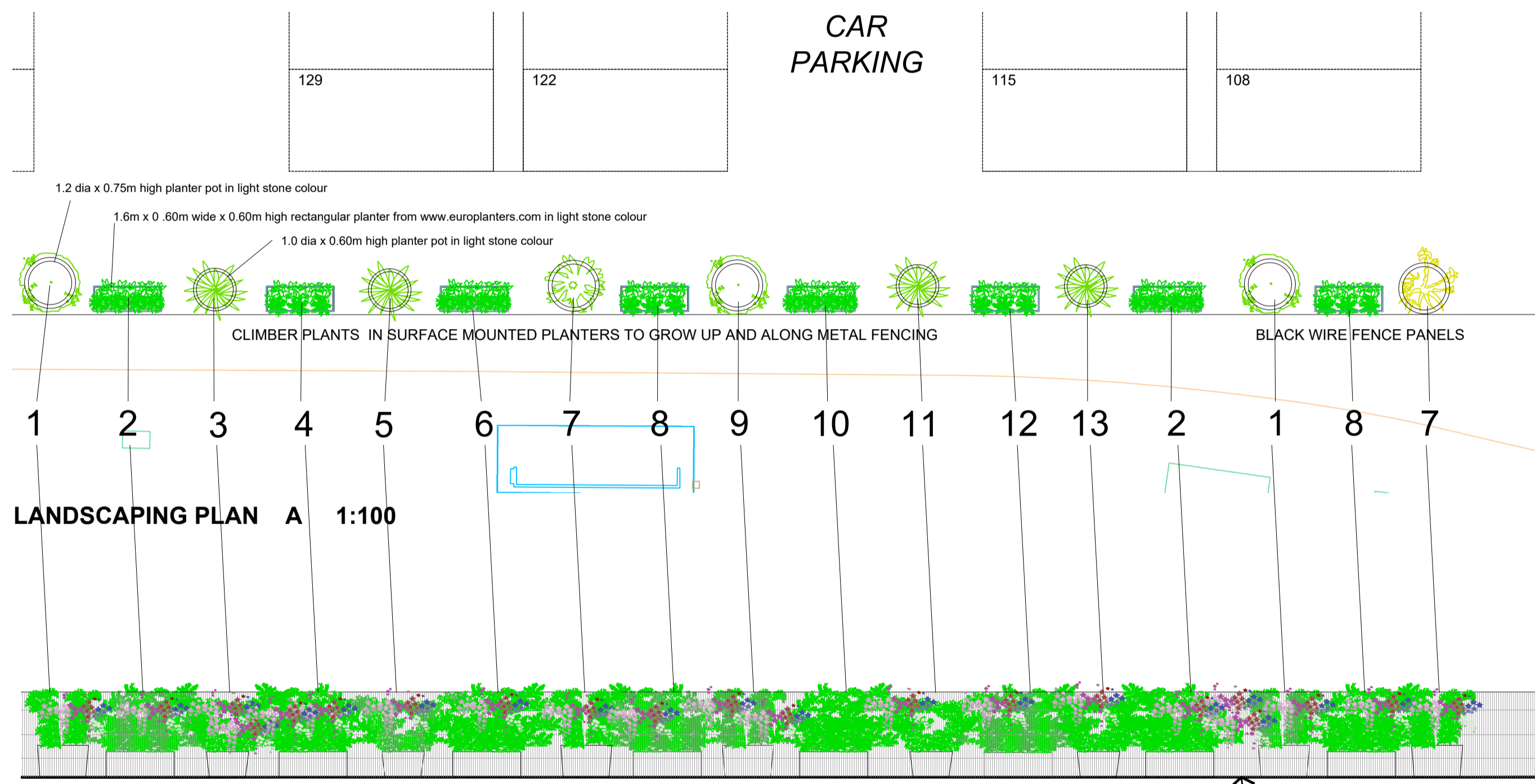

LANDSCAPING PLAN A 1:100

LANDSCAPING P-LAN A ELEVATION 1:100

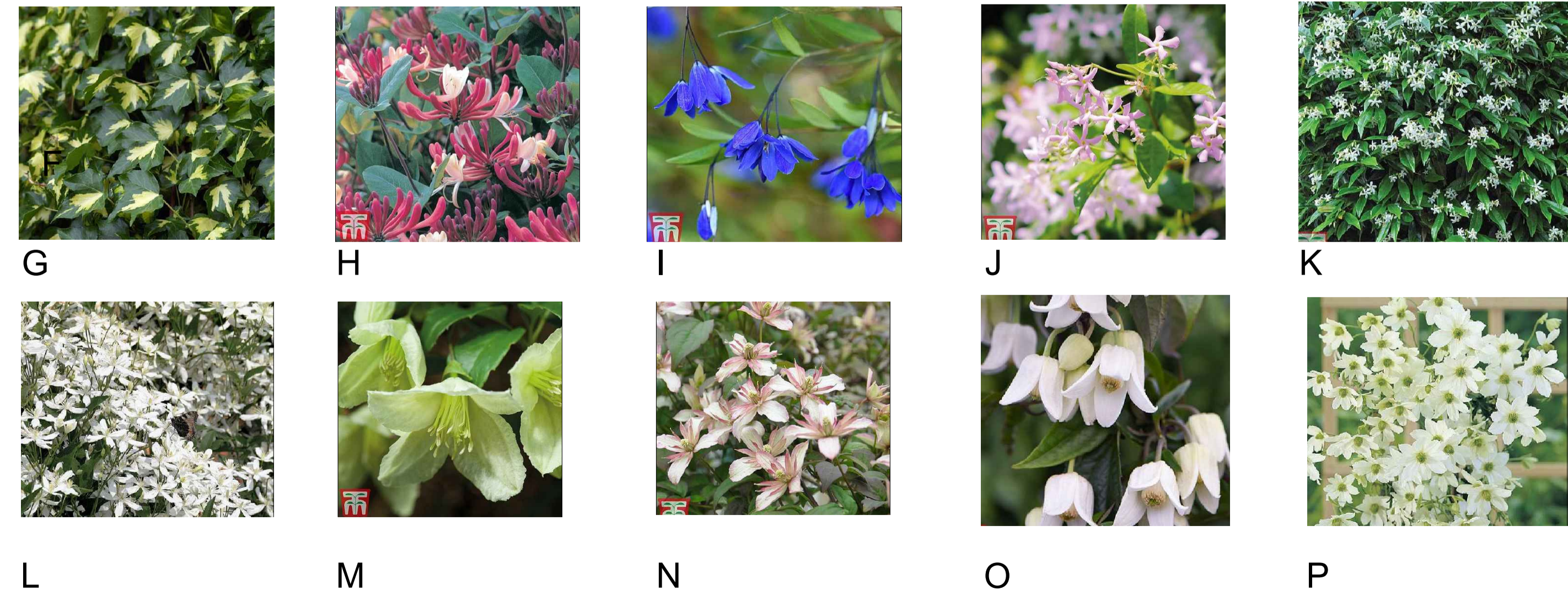

- G - Hedera helix 'Goldheart'
- H - Honeysuckle 'Dartsworld'
- I - Sollya heterophylla 'Ultra Blue'
- J - Trachelospermum asiaticum
- K - Trachelospermum Jasminoides
- L - Clematis armandii
- M - Clematis cirrhosa 'Jingle Bells'
- N - Clematis montana 'Marjorie'
- O - Clematis urophylla 'Winter Beauty'
- P - Clematis 'Early Sensation'

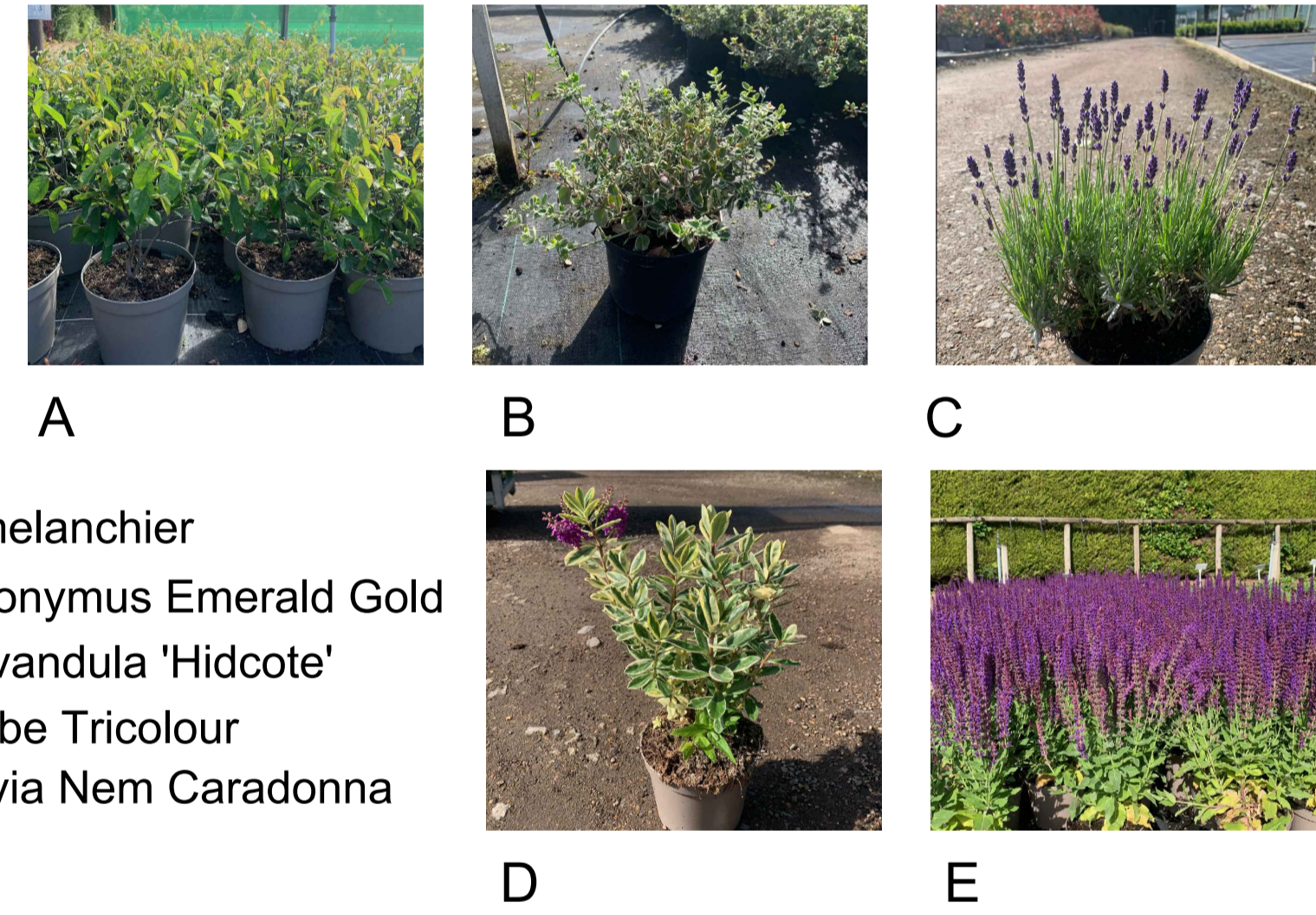

- A - Amelanchier
- B - Euonymus Emerald Gold
- C - Lavandula 'Hidcote'
- D - Hebe Tricolour
- E - Salvia Nem Caradonna

PLANTING SCHEDULE

No	Planter type	Plant Species	Quantity
1	Round 1.2m	A,C,D,E,L	1 of each
2	1.6 x 0.6m	G,I,K,M,P	2 of each
3	Round 1.0m	A,C,D,H	1 of each
4	1.6 x 0.6m	G,H,M,O,P	2 of each
5	Round 1.0m	A,B,C,D,N	1 of each
6	1.6 x 0.6m	G,I,L,N,O,P	2 of each
7	Round 1.2m	A,C,D,E,I,P	1 of each
8	1.6 x 0.6m	G,J,M,O,P	2 of each
9	Round 1.2m	A,B,C,D,E,K	1 of each
10	1.6 x 0.6m	G,H,L,N,O	2 of each
11	Round 1.0m	B,C,D,E,J	1 of each
12	1.6 x 0.6m	G,J,K,M,P	2 of each
13	Round 1.0m	A,C,D,E,O	1 of each
14	Round 1.2m	A,B,C,D,E	1 of each
15	Round 1.0m	B,C,D,E	1 of each
16	Round 1.0m	B,C,D,E	1 of each
17	Round 1.2m	A,B,C,D,E	1 of each
18	Round 1.0m	B,C,D,E	1 of each
19	Round 1.2m	A,B,C,D,E	1 of each
20	Round 1.2m	A,B,C,D,E	1 of each
21	Round 1.2m	A,B,C,D,E	1 of each

Amendments	By	Date
A Landscaping revised along Victoria and Harcourt Avenues.	RB	25.06.20

BUILDER INFORMATION: DO NOT SCALE FROM DRAWINGS. ONLY USE FIGURED DIMENSIONS.

Prior building works must be instructed by the client.

It is essential that all client/builders notes are instructed by the client as per the Architects/Engineers request.

Failure to complete these instructions could have a cost implication on the tender stage or even the feasibility to deliver the project as proposed.

It is solely the responsibility of the client to instruct these works so that the information is available prior to build.

Client and Builder Notes 1 (CBN1)

Trial pits to be carried out to expose all interface areas between the existing and new building. To be checked by contractor prior to building works commencing and information to be relayed back to the Architect.

Client and Builder Notes 2 (CBN2)

Drainage search to be carried out. Client to instruct prior to formal planning submission. To be checked by contractor prior to building works commencing and information to be relayed back to the Architect.

Client and Builder Notes 3 (CBN3)

Client budget awaiting confirmation so that a cost plan can be commissioned.

STATUS: PROPOSED

PROJECT STAGE: RIBA STAGE 5	DRAWN BY: RB	CHECKED BY: SK
CLIENT: Randall Watts	PROJECT: Beaumont Court and Richmond House, SOS	PERIOD: xxx
PROJECT NO: 279-03-15	RIBA NO: 6103	REVISION: A
DRAWING: Proposed Landscaping	PACK: REV: -	SCALE: 1:230 on A1
		MAY 2020

BUILDER INFORMATION: DO NOT BUILD FROM ANY DRAWINGS PACKAGES THAT DO NOT SAY 'BUILDING CONTROL APPROVED OR IN CONSTRUCTION PACKAGES'. IT IS THE RESPONSIBILITY OF THE BUILDER TO CONTACT THE ARCHITECT TO REQUEST/CONFIRM THE RIGHT DRAWING PACKAGE IS ON SITE. PLEASE BE ADVISED THAT ALL DRAWING PACKAGES WILL ALSO HAVE STRUCTURAL ENGINEERING WORKS ATTACHED. DO NOT BUILD WITHOUT ALL PAPERWORK.

DRAWING NOTES: ALL ITEMS, NOTES, DIMENSIONS AND GENERAL DESIGN CONTAINED IN THIS DRAWING ARE FOR GUIDANCE PURPOSES ONLY. NOMINATED BUILDER AND PERSON RESPONSIBLE FOR THE PROJECT SHOULD MAKE A THOROUGH CHECK PRIOR TO COMMENCEMENT OF WORKS AGAINST SITE. DRAINAGE SERVICE DRAWINGS, CURRENT BUILDING REGULATIONS, BRITISH STANDARDS AND CODES OF PRACTICE. FAILURE TO DO SO WILL BE AT THE LIABILITY OF THE BUILDER/CONTRACTOR NOT THE ARCHITECT.

THE CONTRACTOR IS TO ALLOW WITHIN THEIR PRICE FOR ALL ITEMS NOT LISTED BUT THAT WILL BE REQUIRED TO COMPLETE THE WORK IN ACCORDANCE WITH ALL CURRENT LEGISLATION.